

"Aggressively Pursuing Your Real Estate Needs"

16225-16237 Ryerson Road New Berlin, WI 53151



LEASE RATE:
Office (2nd Floor)
\$6.00/SF Modified Gross

CONTACT:
Zach Noble
Zach@dickmanrealestate.com
Cale Berg
Cale@dickmanrealestate.com
(414) 271.6100

Industrial Space for Lease

Building Size:	25,552 SF
Space Available:	(2nd Floor Office Suites)
Office Suite 1:	1,890 SF - \$ 945/Month
Office Suite 2:	1,450 SF - \$ 725/Month
Combined:	3,340 SF - \$1,670/Month
Site Size:	1.54 Acres
Year Built:	1968
Zoning:	M-1 Light Industrial
Clear Height:	17' in Warehouse
Loading:	(1) Loading Dock (3) Drive-In Doors
Construction:	Masonry Block
Utilities:	Municipal
Roof:	Rubber Membrane/Ballisted
Power:	3 phase, 240/480 volt, 400 amp
Parking:	69 Striped Stalls
HVAC:	Fully Air Conditioned
Comments:	<ul style="list-style-type: none">- Excellent access to I-43 and I-94 via Moorland Road- Suites are located on 2nd Floor (stairway access only)- Suites can be rented separately or combined to suit tenants needs.- Each suite is a mix of private offices, open bullpen area, conference rooms, and kitchenette- Tenant improvement allowance available to re-configure layout, carpet, paint, etc- Ample parking- Motivated owner willing to negotiate

BROKER DISCLOSURE TO NON-RESIDENTIAL CUSTOMERS

1 Prior to negotiating on your behalf the Broker must provide you the following disclosure statement:

2 **BROKER DISCLOSURE TO CUSTOMERS**

3 You are a customer of the broker. The broker is either an agent of another party in the transaction or a subagent of another broker
4 who is the agent of another party in the transaction. The broker, or a salesperson acting on behalf of the broker, may provide
5 brokerage services to you. Whenever the broker is providing brokerage services to you, the broker owes you, the customer, the
6 following duties:

- 7 ■ The duty to provide brokerage services to you fairly and honestly.
- 8 ■ The duty to exercise reasonable skill and care in providing brokerage services to you.
- 9 ■ The duty to provide you with accurate information about market conditions within a reasonable time if you request it, unless
10 disclosure of the information is prohibited by law.
- 11 ■ The duty to disclose to you in writing certain material adverse facts about a property, unless disclosure of the information is
12 prohibited by law (See Lines 47-55).
- 13 ■ The duty to protect your confidentiality. Unless the law requires it, the broker will not disclose your confidential information or the
14 confidential information of other parties (See Lines 22-39).
- 15 ■ The duty to safeguard trust funds and other property the broker holds.
- 16 ■ The duty, when negotiating, to present contract proposals in an objective and unbiased manner and disclose the advantages and
17 disadvantages of the proposals.

18 Please review this information carefully. A broker or salesperson can answer your questions about brokerage services, but if you
19 need legal advice, tax advice, or a professional home inspection, contact an attorney, tax advisor, or home inspector.

20 This disclosure is required by section 452.135 of the Wisconsin statutes and is for information only. It is a plain-language summary of
21 a broker's duties to a customer under section 452.133 (1) of the Wisconsin statutes.

22 **CONFIDENTIALITY NOTICE TO CUSTOMERS**

23 BROKER WILL KEEP CONFIDENTIAL ANY INFORMATION GIVEN TO BROKER IN CONFIDENCE, OR ANY INFORMATION
24 OBTAINED BY BROKER THAT HE OR SHE KNOWS A REASONABLE PERSON WOULD WANT TO BE KEPT CONFIDENTIAL,
25 UNLESS THE INFORMATION MUST BE DISCLOSED BY LAW OR YOU AUTHORIZE THE BROKER TO DISCLOSE PARTICULAR
26 INFORMATION. A BROKER SHALL CONTINUE TO KEEP THE INFORMATION CONFIDENTIAL AFTER BROKER IS NO LONGER
27 PROVIDING BROKERAGE SERVICES TO YOU.

28 THE FOLLOWING INFORMATION IS REQUIRED TO BE DISCLOSED BY LAW:

- 29 1. MATERIAL ADVERSE FACTS, AS DEFINED IN SECTION 452.01 (5g) OF THE WISCONSIN STATUTES (SEE LINES 47-55).
 - 30 2. ANY FACTS KNOWN BY THE BROKER THAT CONTRADICT ANY INFORMATION INCLUDED IN A WRITTEN INSPECTION
31 REPORT ON THE PROPERTY OR REAL ESTATE THAT IS THE SUBJECT OF THE TRANSACTION.
- 32 TO ENSURE THAT THE BROKER IS AWARE OF WHAT SPECIFIC INFORMATION YOU CONSIDER CONFIDENTIAL, YOU MAY LIST
33 THAT INFORMATION BELOW (SEE LINES 35-36). AT A LATER TIME, YOU MAY ALSO PROVIDE THE BROKER WITH OTHER
34 INFORMATION YOU CONSIDER TO BE CONFIDENTIAL.

35 **CONFIDENTIAL INFORMATION:** _____

36 _____

37 **NON-CONFIDENTIAL INFORMATION** (The following information may be disclosed by Broker): _____

38 _____

39 *(INSERT INFORMATION YOU AUTHORIZE THE BROKER TO DISCLOSE SUCH AS FINANCIAL QUALIFICATION INFORMATION.)*

40 **CONSENT TO TELEPHONE SOLICITATION**

41 I/We agree that the Broker and any affiliated settlement service providers (for example, a mortgage company or title company) may
42 call our/my home or cell phone numbers regarding issues, goods and services related to the real estate transaction until I/we
43 withdraw this consent in writing. **List Home/Cell Numbers:** _____

44 **SEX OFFENDER REGISTRY**

45 *Notice: You may obtain information about the sex offender registry and persons registered with the registry by contacting the*
46 *Wisconsin Department of Corrections on the Internet at: <http://offender.doc.state.wi.us/public/> or by phone at 608-240-5830.*

47 **DEFINITION OF MATERIAL ADVERSE FACTS**

48 A "material adverse fact" is defined in Wis. Stat. § 452.01(5g) as an adverse fact that a party indicates is of such significance, or that
49 is generally recognized by a competent licensee as being of such significance to a reasonable party, that it affects or would affect
50 the party's decision to enter into a contract or agreement concerning a transaction or affects or would affect the party's decision
51 about the terms of such a contract or agreement. An "adverse fact" is defined in Wis. Stat. § 452.01(1e) as a condition or occurrence
52 that a competent licensee generally recognizes will significantly and adversely affect the value of the property, significantly reduce
53 the structural integrity of improvements to real estate, or present a significant health risk to occupants of the property; or information
54 that indicates that a party to a transaction is not able to or does not intend to meet his or her obligations under a contract or
55 agreement made concerning the transaction.

No representation is made as to the legal validity of any provision or the adequacy of any provision in any specific transaction.

"Aggressively
Pursuing Your
Real Estate
Needs"

**16225-16237 Ryerson Road
New Berlin, WI 53151**

THE
DICKMAN
COMPANY, INC.
REAL ESTATE



CONTACT:
Zach Noble
Zach@dickmanrealestate.com
Cale Berg
Cale@dickmanrealestate.com
(414) 271.6100

THE
DICKMAN
COMPANY, INC.
REAL ESTATE

CORFAC
International

626 E. Wisconsin Avenue • Suite 1020 • Milwaukee, Wisconsin 53202 • Phone: (414) 271-6100 • Fax: (414) 271-5125

Information contained herein was provided by Seller, Lessor and/or third parties. While it is believed to be reliable, Broker makes no warranty or representation as to the accuracy thereof.

DATE	2.7.13
REVISIONS	As noted
DRAWN	MDH
PROJECT	2008.10
SHEET	A1
OF

SJB Properties LLC
 16225-16237 W Ryerson Rd.
 New Berlin, WI 53205
 414

As Built Survey
 UNLIMITED
 Michael Healy, AIA
 Owner/Architect

3550 Burlawn Parkway
 Brookfield, WI 53005
 Voice & Fax
 262 . 781 . 4449
 mdh@asbillsurvey.com

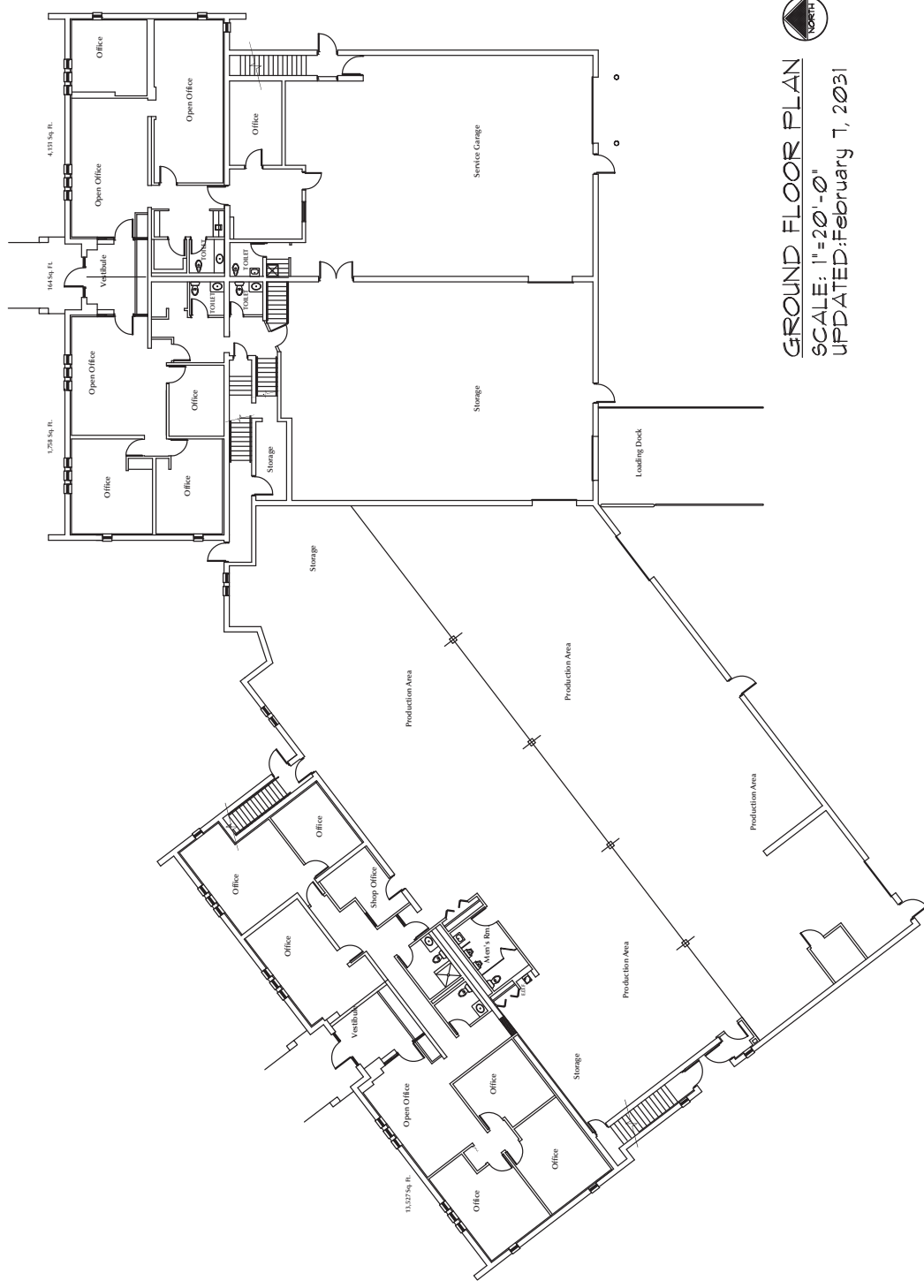

GROUND FLOOR PLAN
 SCALE: 1"=20'-0"
 UPDATED: February 7, 2013

DATE	2.7.13
REVISIONS	As noted
DRAWN	MDH
PROJECT	2008.10
SHEET	A1
OF

